

# SMTPLUS-1

## PEEL-OFF KIT

INSTALLATION GUIDE

ENGLISH

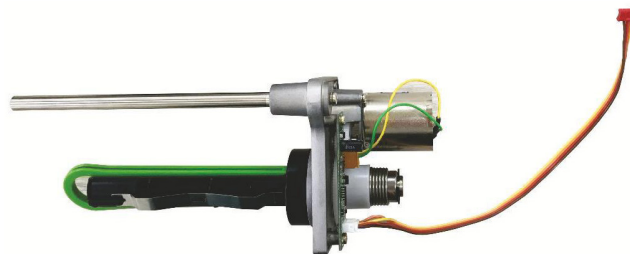

# BAR CODE PRINTER SERVICE MANUAL

## Peel-off Kit Installation (Option)

### LIST OF PEEL-OFF KIT PARTS:

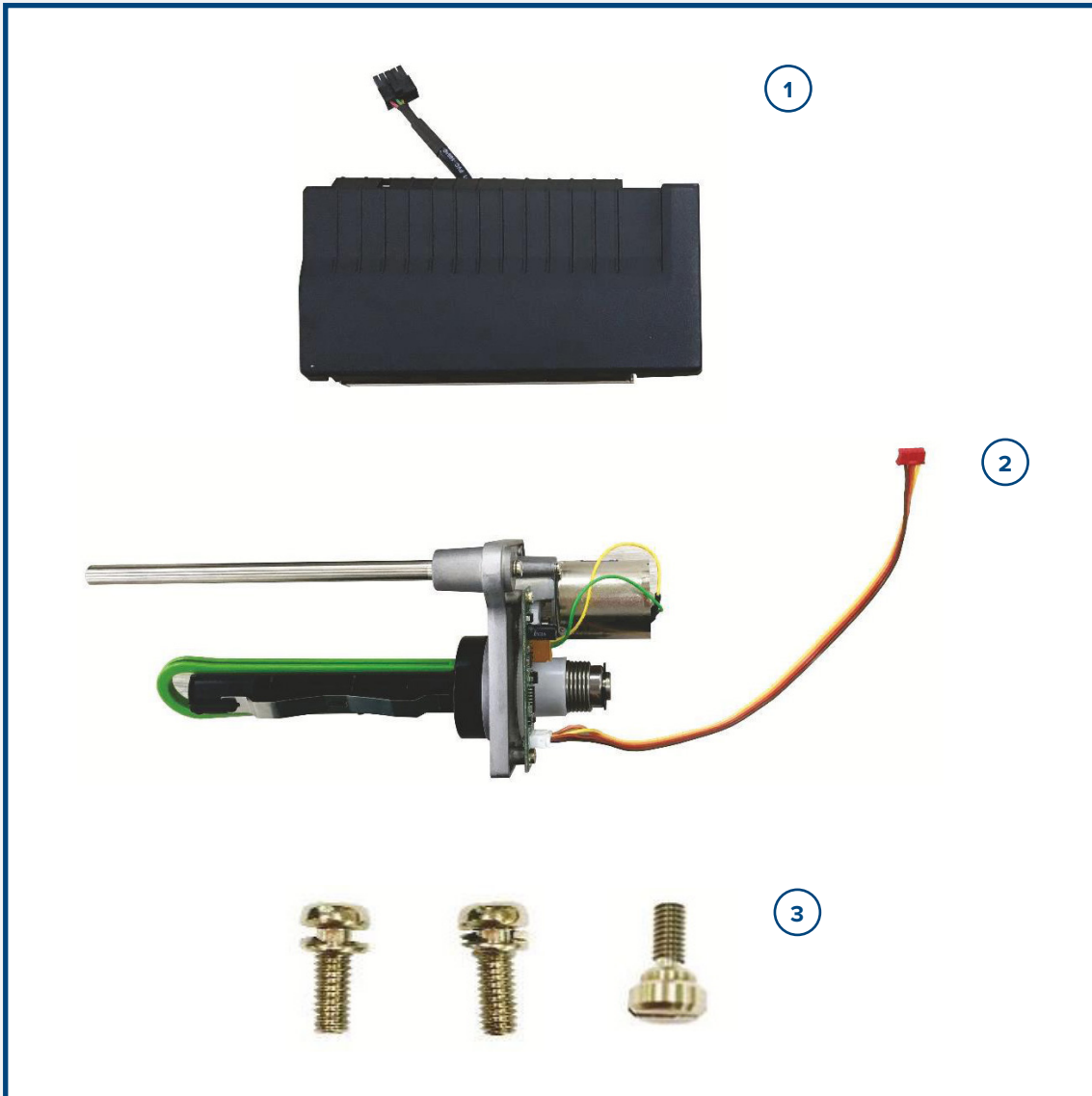

- ① Peel-off Module
- ② Media Rewind Spindle and Media Guide Bar Module
- ③ Two Screws and One Shoulder Screw

## A. Peel-off Sensor Module Installation

### 1. Remove the Lower Front Panel:

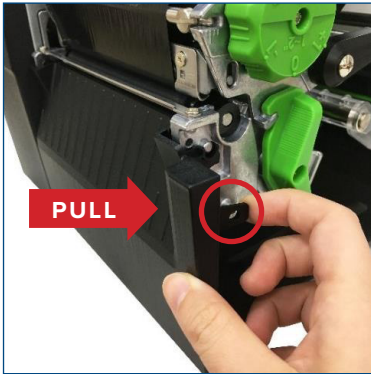

1.1. Open the media cover.

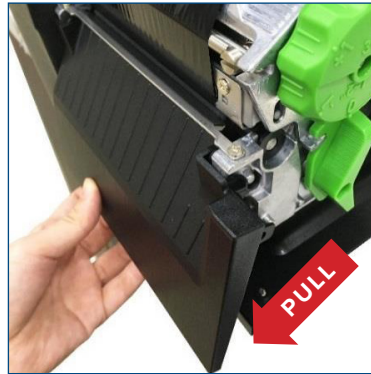

1.2. Move the tab outward then pull the panel inward to remove the lower front panel.



Lower Front Panel

1.3. Reassemble.

### 2. Install Peel-off Sensor Module cable on printer connector as indicated.

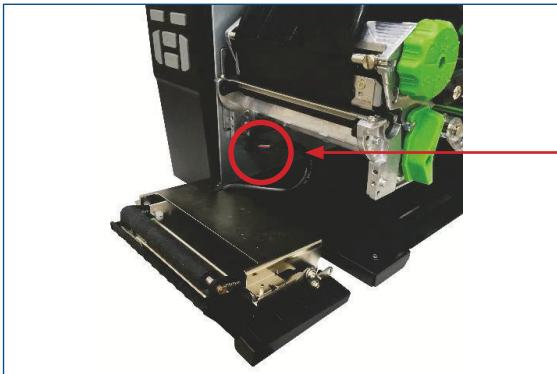

CONNECTOR



*Please push the cable to bottom side to prevent media stuck when peeling the label.*

### 3. Place the Peel-off Sensor Module on locating holes and fix two Screws and one shoulder screw as indicated.

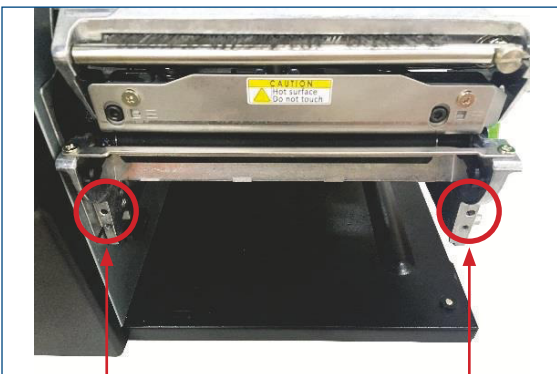

LOCATING HOLES

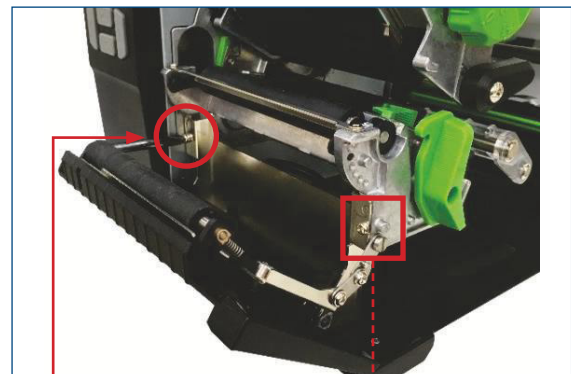

SCREWS



**4. Close the peel-off sensor module and complete installation.**



**5. Remove / Replace the peel-off sensor module by reversing the procedures above.**

## B. Rewind Spindle and Media Guide bar Installation

1. Remove the panel covering the electronics.

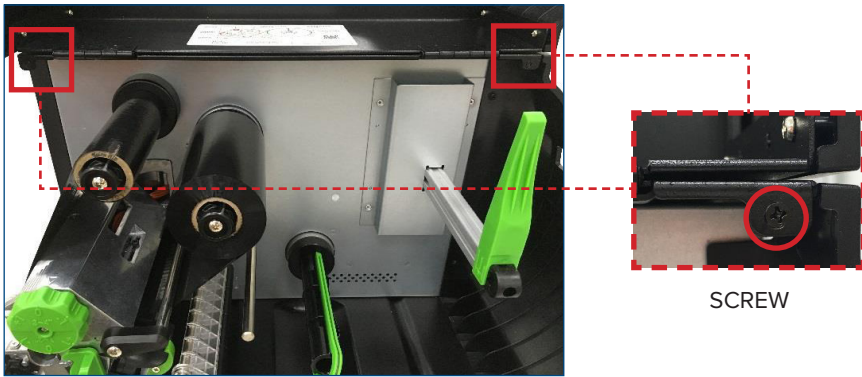

1.1. Open the printer right side cover and remove two screws on the panel covering the electronics.

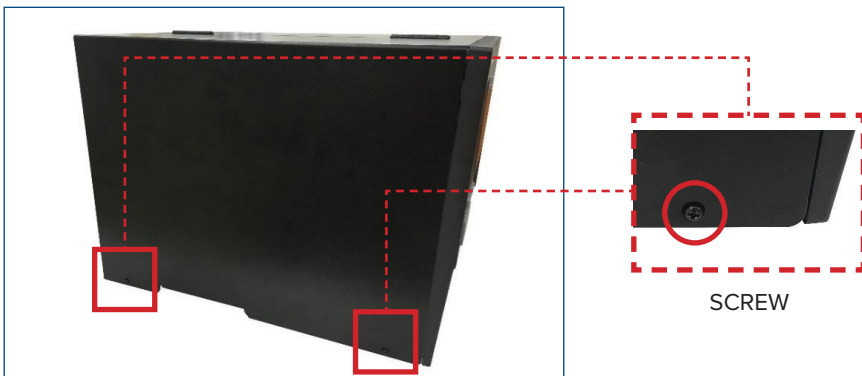

1.2. Turn the printer to left side and remove two screws on the panel covering the electronics.

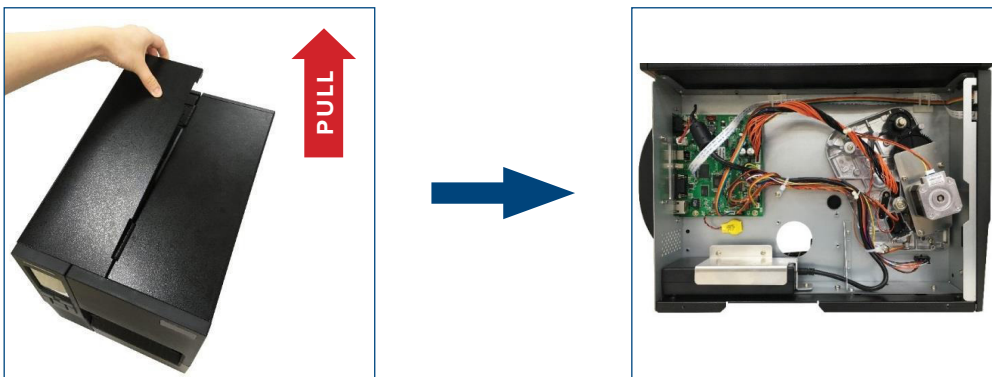

1.3. Remove the panel covering the electronics.

**2. Install the rewind spindle and media guide bar on the side of electronics.**



**3. Fasten three screws on rewind spindle and media guide bar module as indicated.**

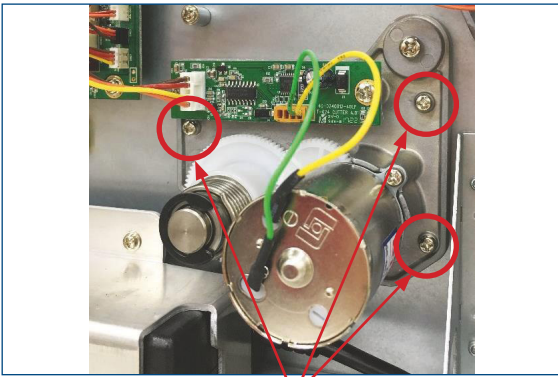

SCREWS

**4. Disconnect the power cord than insert the rewriter power cable to the main board socket as indicated.**

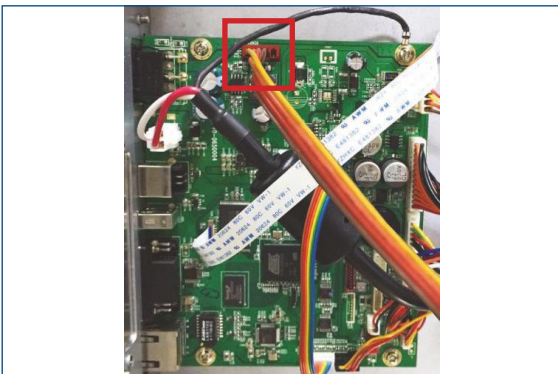

5. Remove / Replace the rewind spindle and media guide bar module.

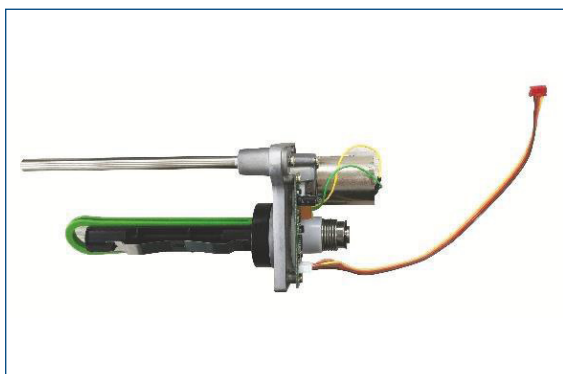

6. Reassemble the parts by reversing the procedures above.



A RICE LAKE WEIGHING SYSTEMS COMPANY

**HEAD OFFICE**

Via Della Fisica, 20  
41042 Spezzano di Fiorano, Modena - Italy  
Tel. +39 0536 843418 - Fax +39 0536 843521

**SERVICE ASSISTANCE**

Via Dell'Elettronica, 15  
41042 Spezzano di Fiorano, Modena - Italy  
Tel. +39 0536 921784 - Fax +39 0536 926654

[www.diniargeo.com](http://www.diniargeo.com)

Authorized service center stamp

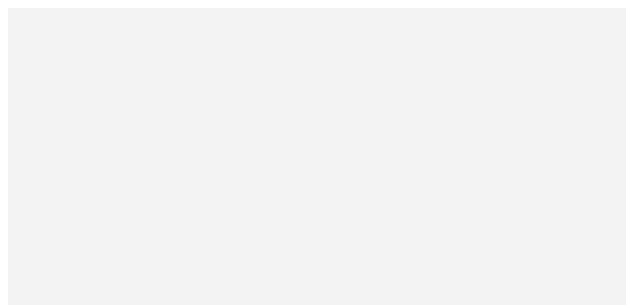

The information in this document is approximate and can be subject to variations without prior notice by Dini Argeo, with respect of the norms in force. The official technical data is available in the updated version on the [www.diniargeo.com](http://www.diniargeo.com) website or by contacting the Dini Argeo Customer Service.