

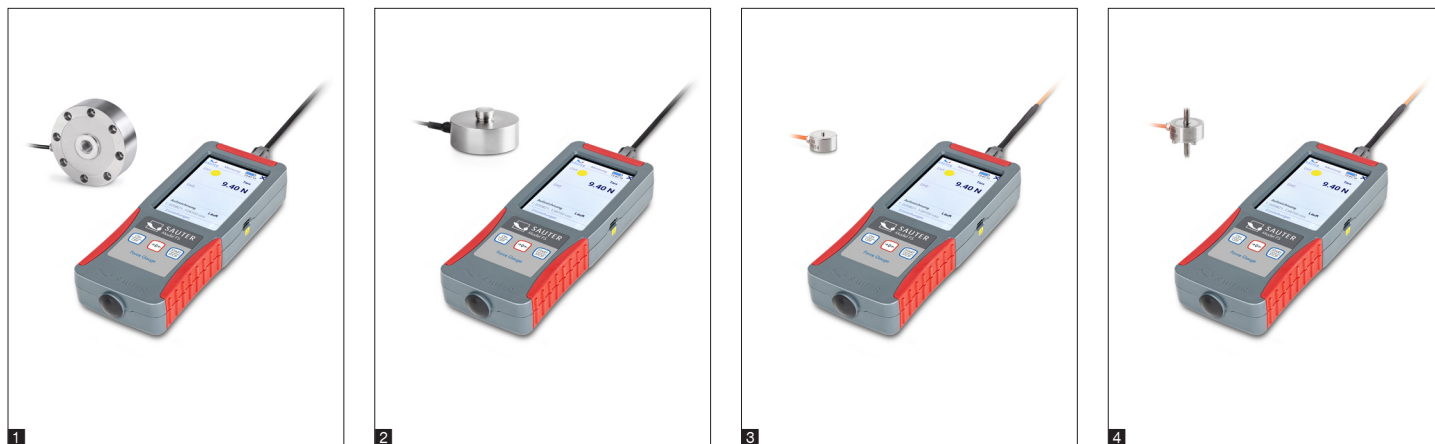

Practical set of premium force gauge and measuring cell

Features

- Thanks to several versions, the pre-configured sets are suitable for tensile and compressive force measurements in a wide range of applications. The set includes the premium force gauge FS 2 and the necessary service FS 401 – FS 408
- It is supplemented optionally by:
 - FS SP1: 4-wire “S” measuring cell made of nickel-plated steel for force and mass measurement (CS P1). For tensile force and compressive force measurements, see larger picture
 - **1** FS RY1: Loadcell made of steel alloy (CR Y1). For tensile force and compressive force measurements
 - **2** FS RQ1: Load cell made of stainless steel (CR Q1). For compressive force measurements
 - **3** FS OY1: Miniature cylindrical load cell made from stainless steel (CO Y1). For compressive force measurements
 - **4** FS OY2: Miniature cylindrical load cell made from stainless steel (CO Y2). For tensile force and compressive force measurements



Accessories

- For subsequent expansion to 4 measuring channels, A/D converter module, only for FS 2 and FS 2-xxx models, SAUTER FS 34
- Max ≤ 10.000 N: Transport case, e.g. for accessories, SAUTER FS TKZ
- Plug-In for data transfer of measuring data from the measuring instrument and transfer to a PC, e.g. in Microsoft Excel®, SAUTER AFI-2.0, see *internet*
- Holders for object fixation and other accessories, please see www.sauter.eu

STANDARD										OPTION		
FS SP1, FS RY1, FS OY2										≤ 5 kN		

Model	Measuring range [Max] N	Readability [d] N	Load cell in the set	Option DAkKS Calibration Certificate (≤ 5 kN)/ Factory calibration certificate (> 5 kN)		
				Tensile Force	Compressive Force	Tensile/Compressive Force
SAUTER				KERN	KERN	KERN
FS SP1: For tensile force and compressive force measurements						
FS 2-1KSP1	1000	0,2	CS 100-3P1	963-162	963-262	963-362
FS 2-2KSP1	2500	0,5	CS 250-3P1	963-163	963-263	963-363
FS 2-5KSP1	5000	1	CS 500-3P1	963-163	963-263	963-363
FS 2-10KSP1	10000	2	CS 1000-3P1	961-164	961-264	961-364
FS 2-20KSP1	20000	4	CS 2000-3P1	961-164	961-264	961-364
FS 2-50KSP1	50000	10	CS 5000-3P1	961-165	961-265	961-365
FS 2-100KSP1	100000	20	CS 10000-3P1	961-166	961-266	961-366
1 FS RY1: For tensile force and compressive force measurements						
FS 2-5KRY1	5000	1	CR 500-1Y1	963-161	963-263	963-363
FS 2-10KRY1	10000	2	CR 1000-1Y1	961-164	961-264	961-364
FS 2-50KRY1	50000	10	CR 5000-1Y1	961-165	961-265	961-365
FS 2-100KRY1	100000	20	CR 10000-1Y1	961-166	961-266	961-366
FS 2-200KRY1	200000	40	CR 20000-1Y1	961-167	961-267	961-367
2 FS RQ1: For compressive force measurements						
FS 2-25KRQ1	25000	5	CR 2500-1Q1	-	961-265	-
FS 2-50KRQ1	50000	10	CR 5000-1Q1	-	961-265	-
FS 2-100KRQ1	100000	20	CR 10000-1Q1	-	961-266	-
3 FS OY1: For compressive force measurements						
FS 2-500OY1	500	0,1	CO 50-Y1	-	963-261	-
FS 2-2KOY1	2000	0,4	CO 200-Y1	-	963-262	-
FS 2-5KOY1	5000	1	CO 500-Y1	-	963-263	-
FS 2-20KOY1	20000	4	CO 2000-Y1	-	961-264	-
4 FS OY2: For tensile force and compressive force measurements						
FS 2-100OY2	100	0,02	CO 10-Y2	963-161	963-261	963-361
FS 2-500OY2	500	0,1	CO 50-Y2	963-161	963-261	963-361
FS 2-1KOY2	1000	0,2	CO 100-Y2	963-162	963-262	963-362